

Manhattan Community Board 4
(All Fields Must Be Completed)

Liquor License Stipulations Application

| | | | |
|--|---|---|---|
| APPLICANT | | DOING BUSINESS AS (DBA) | |
| 915 Management LLC | | Prova | |
| STREET ADDRESS | | CROSS STREETS | |
| 184 8th Ave 2nd fl 263 W. 19th St | | B/n 19th & 20th Street | |
| OWNER | NAME: | Don Greenbaum | NAME: |
| | PHONE: | (917) 843-9881 | NAME: |
| | FAX: | | NAME: |
| ATTORNEY | NAME: | Frank Palillo | NAME: |
| | PHONE: | (212) 227-1640 | NAME: |
| | FAX: | (212) 349-1724 | NAME: |
| MANAGER | NAME: | Don Greenbaum | NAME: |
| | PHONE: | (917) 843-9881 | NAME: |
| | FAX: | | NAME: |
| LANDLORD | NAME: | Eighth-19th G LLC | NAME: |
| | PHONE: | (212) 279-9100 | NAME: |
| | FAX: | | NAME: |
| DESCRIPTION OF BUSINESS | | | |
| Establishment Type: | | <input type="radio"/> Bar/Tavern <input type="radio"/> Bed & Breakfast <input type="radio"/> Eating Place Beer <input type="radio"/> Cabaret <input type="radio"/> Night Club <input type="radio"/> Hotel <input checked="" type="radio"/> Restaurant <input type="radio"/> Catering Establishment <input type="radio"/> Club (Fraternal Organization - Members Only) <input type="radio"/> Other (Explain): Bar/Arcade | |
| Method of Operation: | | <input checked="" type="radio"/> Restaurant <input type="radio"/> Dance Club <input type="radio"/> Sports Bar <input type="radio"/> Adult Entertainment <input type="radio"/> Wine Bar <input type="radio"/> Pizzeria <input type="radio"/> Cafe <input type="radio"/> Other (Explain): Bar/Arcade | |
| License Type: | | <input checked="" type="radio"/> On-Premise <input type="radio"/> Wine <input type="radio"/> Beer <input type="radio"/> Wine & Beer | |
| APPLICATION TYPE (check one) | New | Has applicant owned or managed a similar business? | <input checked="" type="radio"/> YES <input type="radio"/> NO |
| | | What is/was the name of establishment? | Anemacore LLC |
| | | What is/was the address of the establishment? | 184 8th Avenue |
| | | What were the dates the applicant was involved with this former premise? | 2014 - Present |
| | <input checked="" type="radio"/> Transfer | What is the prior license #? | 1233480 |
| | | What is the expiration date on the prior license? | 8-31-16 |
| | | Are you making any alterations or operational changes? | <input type="radio"/> YES <input checked="" type="radio"/> NO |
| | | If alterations or operational changes are being made, please attach the plans to this form. | |
| | <input type="radio"/> Alteration | What is the current license #? | |
| | | What is the expiration date on the current license? | |
| Please describe the nature of the alterations and attach the plans | | | |

| OPERATIONAL ISSUES | | | | | | | | | | |
|--|--|---|---------------------|--------------------|-----------------------------------|-------------------------------|-------------------------------|----------------------------|---------------------|---|
| HOURS | | MONDAY | TUESDAY | WEDNESDAY | THURSDAY | FRIDAY | SATURDAY | SUNDAY | | |
| | Operation | 11 AM - 3 AM | | | | | | | | → |
| | Music | 11 AM - 3 AM | | | | | | | | → |
| | Kitchen | 12 PM - 2 AM | | | | | | | | → |
| OCCUPANCY | INDOOR | | | | BAR | | | OUTSIDE | | |
| | Capacity (Certificate of Occupancy) | Maximum # of Persons You Anticipate Occupying Premises (Including Employees) | Number of Tables | Number of Seats | Number of Service Only Bars | Number of Stand-Up Bars | Number of Seats at Bars | Number of Seats | Number of Tables | |
| | 144 | 120 | 30 | 75 | 0 | 2 | 32 | N/A | | |
| How many floors are there? What is the capacity for each floor? (please respond in space provided) | | | | | 1-2 | 3-4 | 5+ | | | |
| Will you be applying or intending to apply for a cabaret license? If yes, will there be dancing? (please respond in space provided) | | | | | YES | NO | N/A | | | |
| Will applicant have bottle service? | | | | | YES | NO | N/A | | | |
| Will you be hosting private parties and promotional events? | | | | | YES | NO | N/A | occasional private parties | | |
| Will outside promoters be used? | | | | | YES | NO | N/A | | | |
| Will the security plan submitted be implemented? | | | | | YES | NO | N/A | | | |
| Will State certified security personnel be used? | | | | | YES | NO | N/A | | | |
| Will New York Nightlife Association recommendations and NYPD Best Practices be followed? | | | | | YES | NO | N/A | | | |
| Will the applicant be using delivery bicycles? If yes, have you applied to DOT for bicycle rack? Delivery bicycles are to be clearly marked with the name of the restaurant and staff will wear attire clearly noting name. (please respond in space provided) | | | | | YES | NO | N/A | | | |
| Will the applicant be applying for a Sidewalk Café now or in the future? (please respond in space provided) | | | | | YES | NO | N/A | | | |
| If yes to the above, are plans attached and submitted to DCA? How many tables/seats? (please respond in space provided) | | | | | N/A | YES | N/A | 66 tables; 8 seats | | |
| Will applicant provide contact information to neighbors and respond to complaints that arise? | | | | | YES | NO | N/A | | | |
| Will you inform the Community Board office of your job openings and/or provide a hyperlink to your jobs webpage? | | | | | YES | NO | N/A | | | |
| If you plan to have music, what type(s)? | | | | | BACKGROUND | LIVE MUSIC | DJ | | | |
| BUILDING DESIGN | | | | | | | | | | |
| Doors and windows will be closed when any amplified music is played and in the event of no amplified sound, will be closed by 11 PM Friday and Saturday and 10 PM on all other days. | | | | | YES | NO | N/A | | | |
| Will applicant follow the recommendations of a certified sound engineer to mitigate potential noise disturbance to the neighboring residents and buildings, including placing speakers on the floor of the establishment? | | | | | YES | NO | N/A | | | |
| Do you agree to comply with DOB rules concerning a storm enclosure? Storm enclosures can be used between November 15 and April 15, but they may NOT project more than 18 inches from the store front.) | | | | | YES | NO | N/A | | | |

| OUTDOOR ITEMS | | | |
|--|--------------------------------------|--------------------------|---------------------------|
| Will applicant use the rooftop, rear yard or any outdoor space? | <input checked="" type="radio"/> YES | <input type="radio"/> NO | <input type="radio"/> N/A |
| If yes to the above, the rear yard, rooftop, and any outdoor space will be closed and vacated by 11 PM on Friday & Saturday and 10 PM on all other days. | <input checked="" type="radio"/> YES | <input type="radio"/> NO | <input type="radio"/> N/A |
| The service and consumption of alcohol in the rear yard, on the rooftop, or in any other outdoor space will be only via seated food service. | <input checked="" type="radio"/> YES | <input type="radio"/> NO | <input type="radio"/> N/A |
| The rear yard, rooftop, and any other outdoor space will not allow standing space for patrons to drink or smoke. | <input checked="" type="radio"/> YES | <input type="radio"/> NO | <input type="radio"/> N/A |
| Applicant will do everything in their power to provide an effective sound baffling or sound controlled environment through landscaping or some type of enclosure, where possible; provided they do not violate any fire or building code regulations? This includes possibly working with landlords for soundproofing tenants apartments (such as installing soundproofing windows, acoustical tiles, etc.). | <input checked="" type="radio"/> YES | <input type="radio"/> NO | <input type="radio"/> N/A |
| Applicant will enforce a quiet environment in the outdoor space, so as not to disturb nearby residents (e.g. there will be no amplified music, as per the law, and windows and doors to areas that play amplified music shall be closed). The applicant will make every effort possible to limit the noise emanating from diners by posting signs outside and also on menus asking for respect of the neighbor's privacy and peace. The staff will also encourage a peaceful environment amongst the outdoor diners. | <input checked="" type="radio"/> YES | <input type="radio"/> NO | <input type="radio"/> N/A |
| Applicant will have a lighting plan that will allow safe usage of the outdoor space without disrupting neighbors? | <input checked="" type="radio"/> YES | <input type="radio"/> NO | <input type="radio"/> N/A |

| LOCATION & ZONING | | | |
|---|--|-------------------------------------|--------------------------------------|
| Primary Zoning District: | C 1-1 | | Overlay (If Applicable): |
| | R-8 | | |
| Is this a Special District? If yes, is it Clinton, West Chelsea or Hudson Yards? | <input checked="" type="radio"/> YES | <input type="radio"/> NO | <input type="radio"/> N/A |
| Does the building have a Certificate of Occupancy ("C of O") or a letter of no objection? | <input checked="" type="radio"/> YES | <input type="radio"/> NO | <input type="radio"/> N/A |
| Is the 500 Foot Rule or 200 Foot Rule Triggered? If yes, which? Please attach a diagram of the establishments that triggers the rule. | <input checked="" type="radio"/> YES | <input type="radio"/> NO | <input type="radio"/> N/A |
| | 500' Rule | | |
| Is a Public Assembly permit required? | <input type="radio"/> YES | <input checked="" type="radio"/> NO | <input type="radio"/> N/A |
| Are your plans filed with DOB? | <input type="radio"/> YES | <input type="radio"/> NO | <input checked="" type="radio"/> N/A |
| Building Type | <input type="radio"/> Residential <input type="radio"/> Commercial <input checked="" type="radio"/> Mixed Use <input type="radio"/> Other, describe: | | |
| Adjacent Buildings | <input type="radio"/> Residential <input type="radio"/> Commercial <input checked="" type="radio"/> Mixed Use <input type="radio"/> Other, describe: | | |
| NOTIFICATION: | # 1 | Community Board # 4 | |
| What organizations / community groups have you notified regarding your application? | # 2 | | |
| | # 3 | | |

ADDITIONAL INFORMATION: (Applicant Use)

ADDITIONAL NOTES: (Office Use Only)

THIS APPLICATION DOES NOT
EXTEND TO OR ENCOMPASS
ANY JEWELRY CASE.

19th STREET DOOR WILL BE
USED ONLY FOR ENTRANCE,
AND NOT EXITING, AFTER
1130 P.M. NIGHTLY.

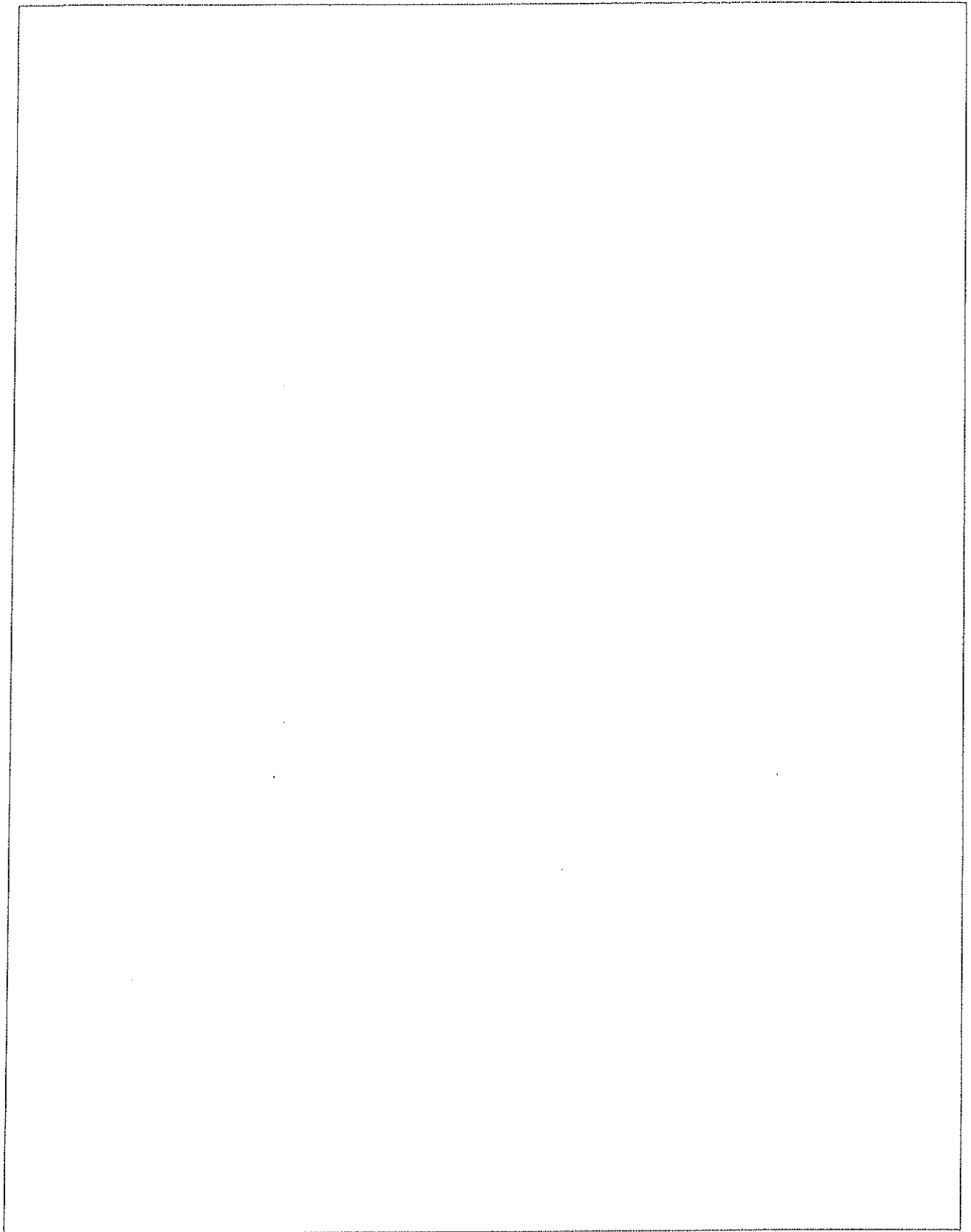

Manhattan Community Board 4 (MCB4) recommends:

☒ Denial unless all agreed to by applicant is part of the method of operation

☐ Denial ☐ Approval

CB4 REPRESENTATIVES

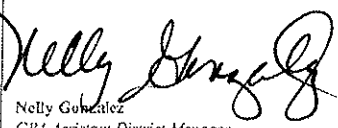
Nelly Gonzalez
CB4 Assistant District Manager

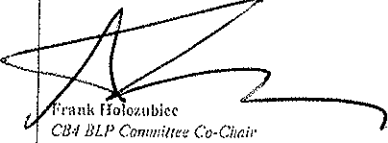

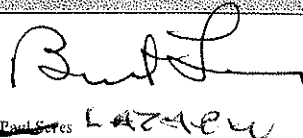
Frank Holozubiec
CB4 BLP Committee Co-Chair

Paul Seres
CB4 BLP Committee Co-Chair

APPLICANT AGREEMENT WITH THE COMMUNITY

Pursuant to these stipulations, this applicant agrees to have these provisions incorporated in the method of operation of their liquor license. Additionally, the applicant agrees to the community agreements as the basis for the community supporting this application.

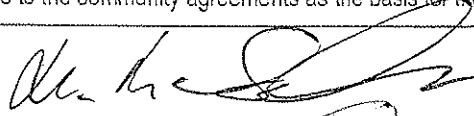
SIGN HERE →



SIGNATURE OF APPLICANT

DATE

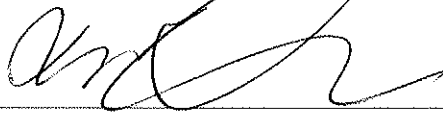
11-13-14

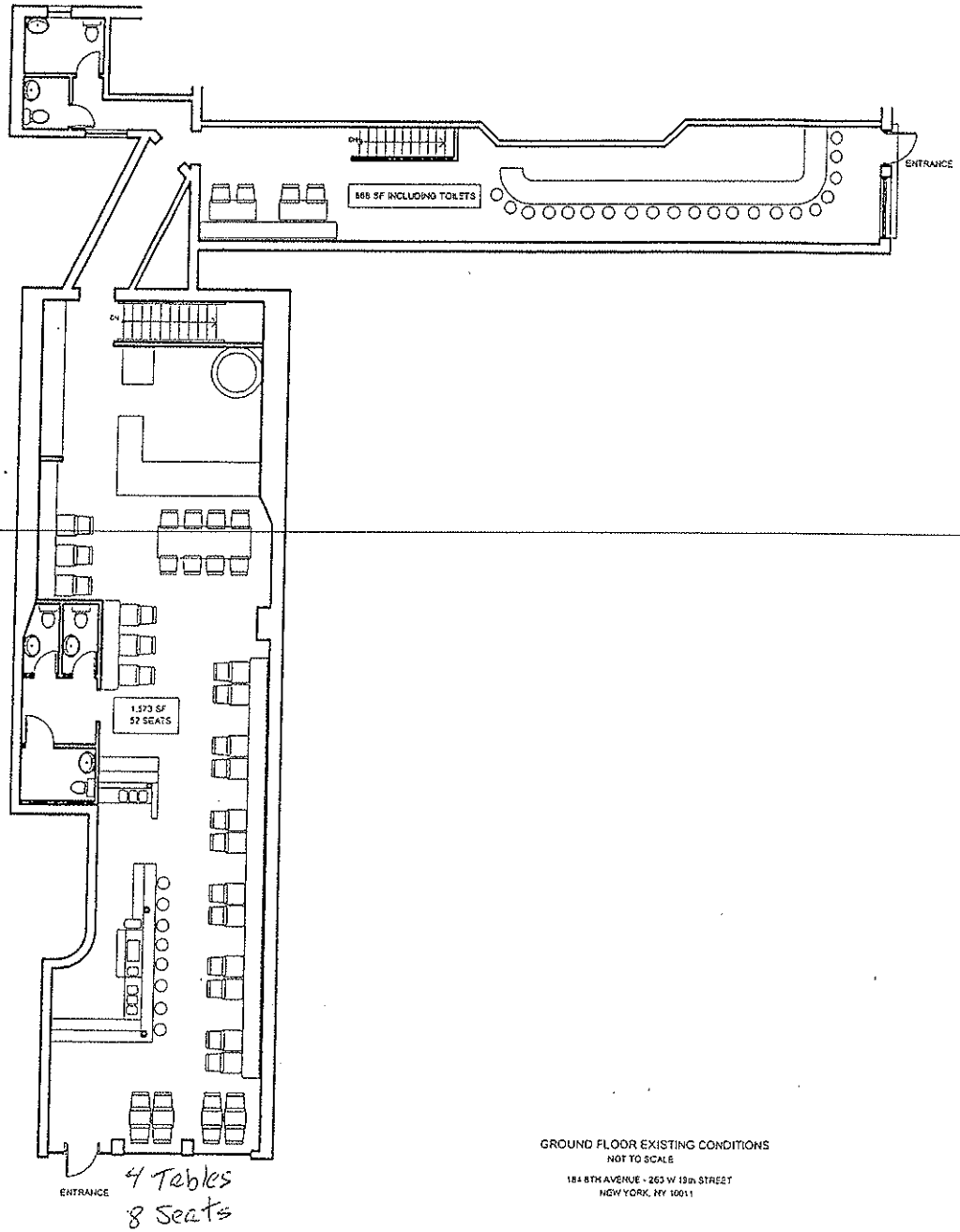

9/9/15



GROUND FLOOR EXISTING CONDITIONS
NOT TO SCALE
184 8TH AVENUE - 263 W 19th STREET
NEW YORK, NY 10011

184 8TH AVENUE

263 WEST 19TH STREET

